

GEARMORE INC.

RIPPER

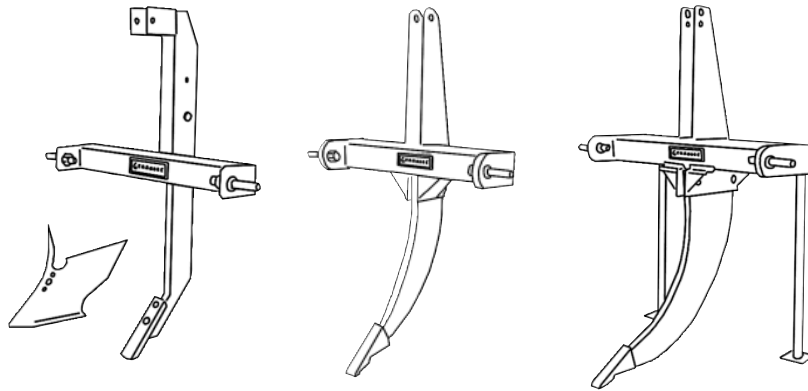

**Operation, Service,
& Parts Manual
For Models GR100, GR200(HF),
& GR300(HF)**

November 2009

TABLE OF CONTENTS

	PAGE
General Information	1
Introduction.....	1
Symbols	1
Operating Instructions	2
Operation Safety	3
Parts Assembly	4 - 6
GR100 Ripper	4
GR200 Ripper	5
GR300 Ripper	6
Limited Warranty	7

GENERAL INFORMATION

INTRODUCTION:

We welcome you as an owner of a Gearmore Ripper. Please read the following instructions and refer to them when required.

ASSEMBLY INSTRUCTIONS:

With normal maintenance you should receive years of use out of the ripper.

1. Inspect unit to make sure all bolts that hold the shank are tight.
2. The shank retainer bolt and the shank shear bolt should not be overtightened. They only need to be tightened enough so that the special nyloc locknut will not back off. Overtightening will cause the mounting plate to squeeze the shank not allowing the shear bolt to shear properly.
3. When ripping, do not turn with the shanks in the ground. Doing so will cause damage to the shanks and frame.
4. Tractors having draft control on their 3-point should be adjusted so that the ripper operates properly when tough ground conditions arise. Review the tractors' operators manual for correct settings.
5. Only replace shear bolts with grade 2 bolts. Using a higher grade bolt will only cause damage to the ripper or tractor.

OPERATION



READ THIS BEFORE OPERATING RIPPER

Know your controls and how to stop the tractor engine and ripper quickly in an emergency.
READ THIS OPERATOR'S MANUAL AND THE MANUAL PROVIDED WITH YOUR TRACTOR.

To avoid accidents or injury, do not allow anyone to operate this equipment without proper instructions. Any person who operates this equipment must be instructed in and be capable of the safe operation of the unit, its attachments and all controls.

DO NOT allow children to operate machine, or adults to operate it without proper instructions.

DO NOT make turns with the shank in the ground. Doing this will cause damage to the shank and frame.

OPERATION

OPERATIONAL SAFETY:

- Read the operator's manual before using any equipment.
- *NEVER* allow children to operate tractor and ripper or other power equipment.
- Know how to stop the tractor quickly in the event of an emergency.
- Instruct children and other persons to stay away from the tractor and ripper when it is in operation.
- *ALWAYS* remove the key when leaving the tractor unattended.
- *NEVER* allow ripper to be left in the "up" position when unattended.
- Give complete undivided attention to the job at hand.
- *NEVER* allow riders.
- Stop the engine when dismounting from the tractor.
- Use caution when operating the tractor on uneven terrain. Decrease speed when making turns. Use front and rear wheel weights as required.
- Add sufficient amount of weight to front end of tractor to prevent wheels from coming off the ground when starting suddenly with a load.

PARTS ASSEMBLY

GR100 RIPPER ASSEMBLY

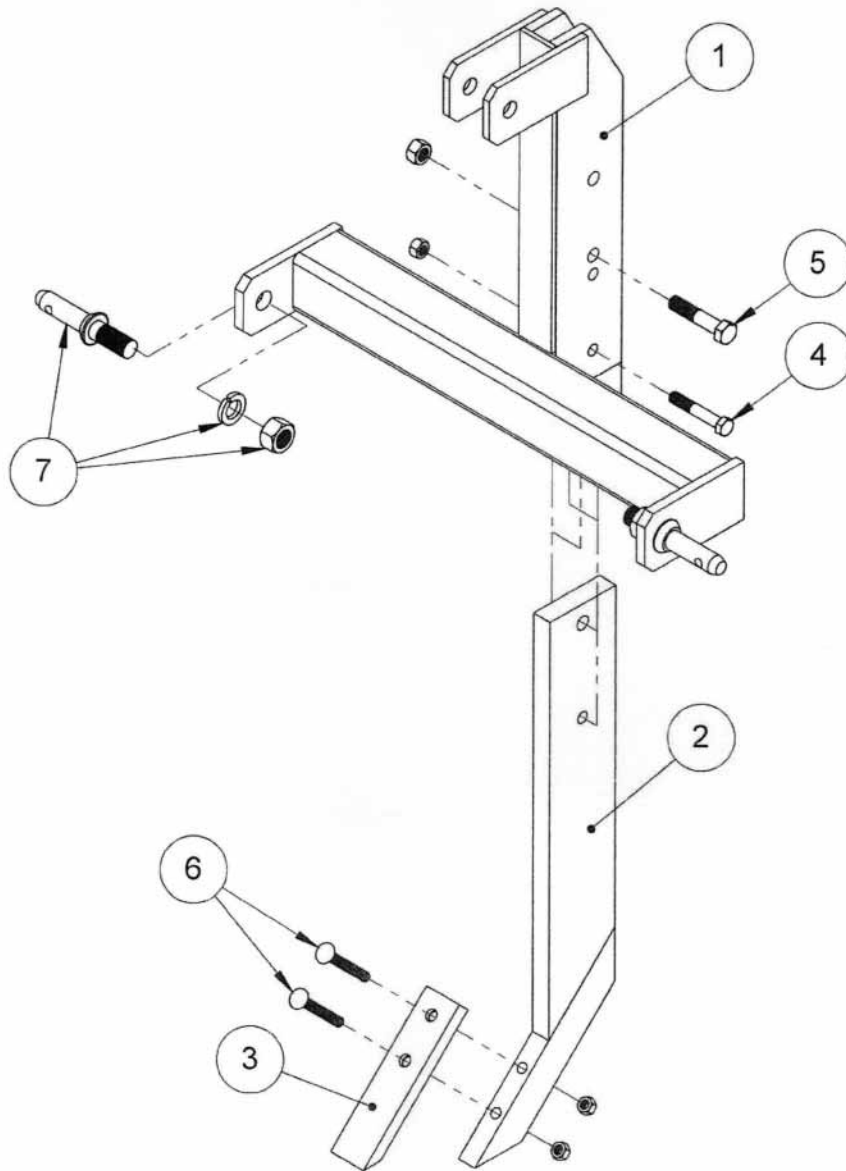

<u>REF.</u>	<u>QTY.</u>	<u>PART NO.</u>	<u>DESCRIPTION</u>
1	1	GR1001	A-Frame Only
2	1	GR1003	Shank Only
3	1	GR1004	Point Only
4	1	GR1005	½" x 3" NC Gr. 2 Cap Screw (w/nylock nut)
5	1	GR1006	⅝" x 3" NC Gr. 5 Cap Screw (w/nylock nut)
6	2	GR1007	⅞" x 3 ½" Gr. 2 Carriage Bolt (w/nut)
7	2	GR1008	Cat. 1 Lift Arm Pin
	1	GR1002	Shank w/Point (Includes ref. 2 & 3)
	1	GR1010	Bolt or Weld-on Shin Guard (mild steel - not shown)
	1	FS10	#615 Furrower (to make ripper into a middle buster - not shown)

PARTS ASSEMBLY

GR200 RIPPER ASSEMBLY

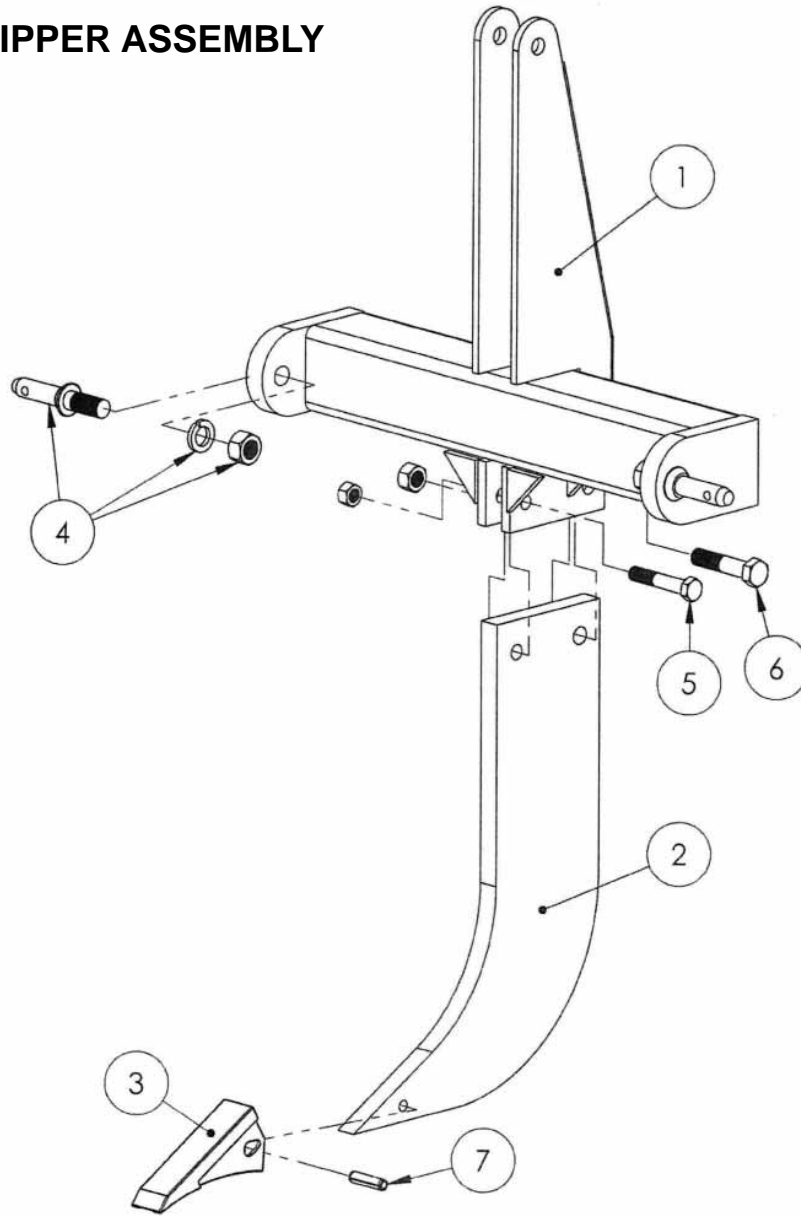

<u>REF.</u>	<u>QTY.</u>	<u>PART NO.</u>	<u>DESCRIPTION</u>
1	1	GR21001	200, 102L, 102 Frame Only
2	1	GR21003	200, 102L Shank without Point, 22"
	1	GR21002	102 Shank without Point, 27" (not shown)
3	1	GR21004	Pengo 210 Point
4	2	GR21005	Cat. 1 Lift Arm Pin
5	1	GR21006	5/8" x 3 1/2" NC Gr. 2 Cap Screw (w/nylock nut)
6	1	GR21007	3/4" x 3 1/2" NC Gr. 5 Cap Screw (w/nylock nut)
7	1	GR21008	1/2" x 2" Roll Pin (for point)
	1	GR21009	102-HF Shank & Point Hard Faced (not shown)
	1	GR21010	200, 102L-HF Shank & Point Hard Faced (not shown)
	1	GR21100	Complete 102 Shank, 27" w/Point & Roll Pin (not shown)
	1	GR21200	Complete 200, 102L shank, 22" w/Point & Roll Pin (includes ref. # 2, 3, & 7)

PARTS ASSEMBLY

GR300 RIPPER ASSEMBLY

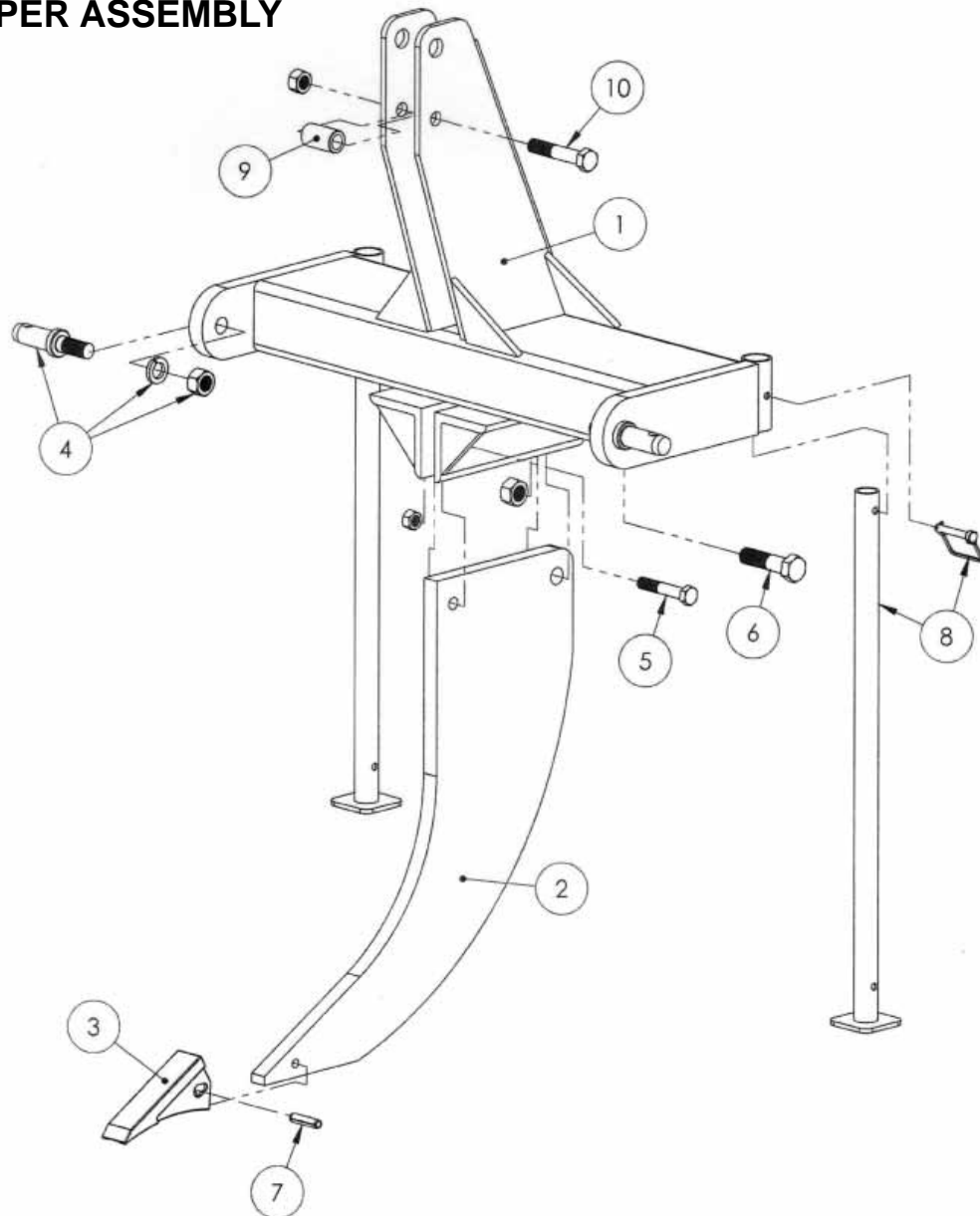

<u>REF.</u>	<u>QTY.</u>	<u>PART NO.</u>	<u>DESCRIPTION</u>
1	1	GR3001	Frame Only
2	1	GR3002	Shank without Point, 1 x 27
3	1	GR3003	Pengo Point
4	2	GR3004	Hitch Pin, $\frac{7}{8}$ Thread, Cat. 2 Pin
5	1	GR3005	$\frac{5}{8}$ " x 3 $\frac{1}{2}$ " NC Gr. 2 Cap Screw (w/nylock nut)
6	1	GR3006	$\frac{7}{8}$ " x 3 $\frac{1}{2}$ " NC Gr. 2 Cap Screw (w/nylock nut)
7	1	GR3007	$\frac{1}{2}$ " x 2" Roll Pin (for point)
8	1	GR3008	Set of 2 Parking Stands w/Pins
	1	GR3009	Hard Faced Shank & Point (not shown)
9	1	GR3010	Top Link Bushing
10	1	GR3011	$\frac{3}{4}$ " x 4" NC Gr. 5 Cap Screw (w/nylock nut)
	1	GR3100	Complete Shank w/Point & Roll Pin

LIMITED WARRANTY



GEARMORE, INC., warrants each new Gearmore product to be free from defects in material and workmanship for a period of twelve (12) months from date of purchase to the original purchaser. This warranty shall not apply to implements or parts that have been subject to misuse, negligence, accident, or that have been altered in any way.

Our obligation shall be limited to repairing or replacement of any part, provided that such part is returned within thirty (30) days from date of failure to Gearmore through the dealer from whom the purchase was made, transportation charges prepaid.

This warranty shall not be interpreted to render us liable for injury or damages of any kind or nature, direct, consequential or contingent, to person or property. This warranty does not extend to loss of crops, loss because of delay in harvesting or any other expenses, for any other reasons.

Gearmore in no way warrants engines, tires, or other trade accessories, since these items are warranted separately by these respective manufacturers.

Gearmore reserves the right to make improvements in design or changes in specification at any time, without incurring any obligations to owners or units previously sold.

GEARMORE, INC.
13477 Benson Ave.
Chino, CA 91710

Always refer to and heed machine operating warning decals on machine.

The serial number of this product is stored in our computer database, thus submitting a warranty registration card is not required.

CUSTOMER INFORMATION

NAME: _____

PURCHASED FROM: _____

DATE OF PURCHASE: _____

MODEL NUMBER: _____

SERIAL NUMBER: _____