

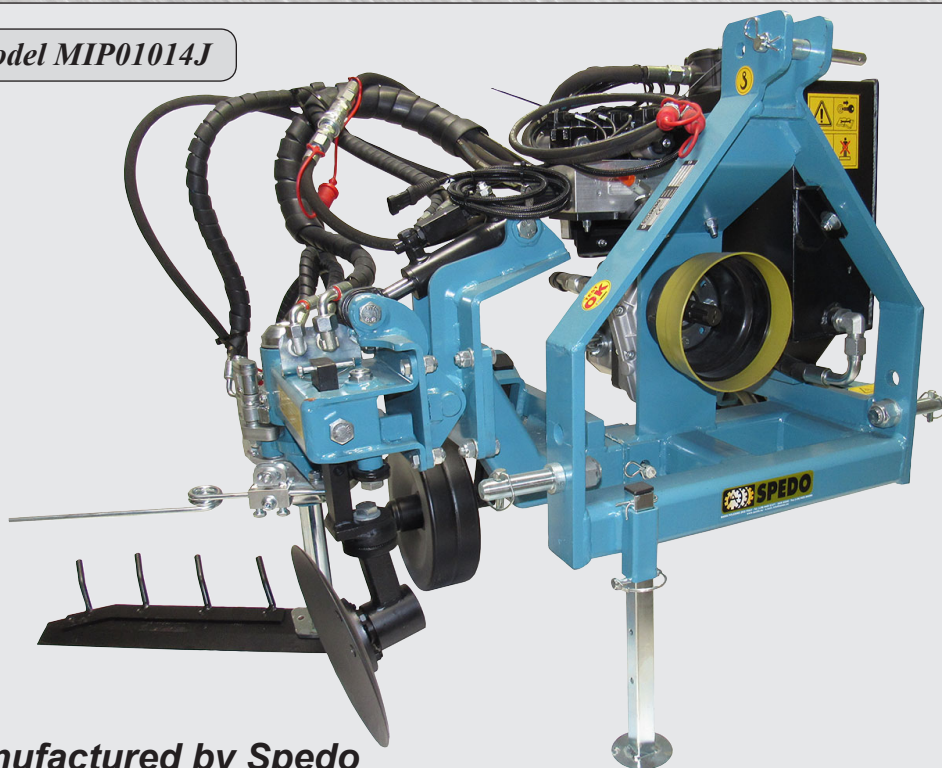

SPEDO IN-ROW CULTIVATORS

IN-ROW MAINTENANCE TOOLS FOR VINEYARDS

Model MIP01014J



Manufactured by Spedo

Very effective tools for under vine maintenance. This in-row blade undercuts weeds, while at the same time loosening and turning back the soil. The cutting blade hydraulically retracts around the base of the vine without damage. The unit was developed for one side weeding only, so as to operate at higher speeds with safe, accurate control. Also, standard is a remote control joystick which allows the operator to retract the blade when required. Many options are available: Retractable 16" Rotary Hoe, 19" Flail Mower, Power Disc, and Back Fill Disc.

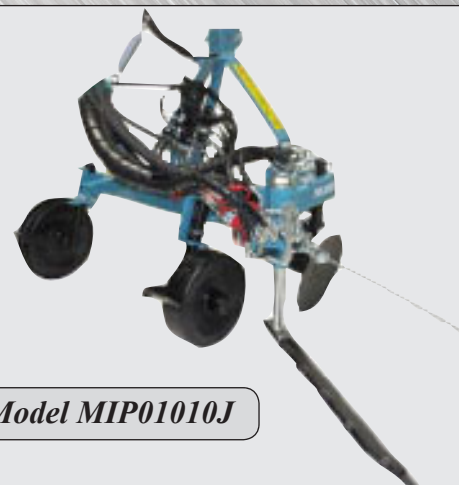

Model MIP01010J



13477 Benson Ave. • Chino, CA 91710
Ph: 909/548-4848 • Fax: 909/548-4747

www.gearmore.com • sales@gearmore.com



IN-ROW CULTIVATOR WITH 4 IMPLEMENTS

FEATURES: BOTH MODELS

- Cat. II, 3-point hitch
- Double tubing main frame
- Manual sliding tube to adjust for different row widths
- Sensor rod for automatic implement retraction
- Double acting hydraulic power for retraction system
- Joystick control from tractor seat for blade retraction when necessary
- 24" Long blade with comb
- Adjustable coulter disc
- Dual gauge wheels with mud scrapers
- Parking stand
- For row widths 6 to 10 feet
- All required hoses are included

ADDED FEATURES: MODEL MIP01014J

- Self contained hydraulic system, PTO driven
- Oil reservoir, pump, and oil cooler
- Hydraulic blade tilt

OPTIONS: Rotary Hoe - 4 Blades 16" w/gauge wheel
Flail Mower - 19" Y blades w/gauge wheel
Power Disc - 3 blade 14"
Back Fill Disc - 2 Blade 14"

NOTE: Tractor requirements minimum 6 G.P.M. with one set of remotes with open center hydraulics and run detent hydraulic system of at least 2000 P.S.I., when using in-row blade only.

SPECIFICATIONS:

MODEL NO:	DESCRIPTION	ROW WIDTHS	WEIGHT
MIP01010J	in-row cultivator, blade mount only using tractor hydraulics	6' to 12'	700 #
MIP01014J	in-row cultivator w/self contained hydraulic system, add implements	6' to 12'	800 #



Rotary Hoe - 16" Retractable



Flail Mower - 19 " Retractable

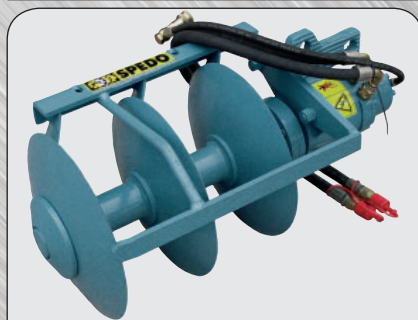

Power Disc - 3 Blades Retractable

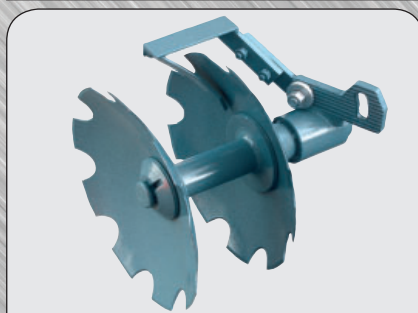

Back Fill Disc - 14 " 2 Blades

Specifications Subject To Change Without Notice

13477 Benson Ave. • Chino, CA 91710 • Ph: 909/548-4848 • Fax: 909/548-4747